

Super Yacht

i n d u s t r y

Italy

YACHT BUILDERS & SUPPLIERS

Blue Eyes

MORE THAN MEETS THE EYE

Refit & Repair

KEEPING THE COMPETITIVE EDGE

Candyscape II

A GREEN STAR IS BORN



Candyscape II

The Next Difference



CANDYSCAPE II

BUILDER
DESIGNER
NAVAL ARCHITECT
INTERIOR DESIGNER

Viareggio Super Yachts
Espen Oeino International
Studio Ing. A. Arnaboldi
Candy & Candy London



Delivered in September 2009, Candyscape II is the first superyacht completed by Italian newcomer Viareggio SuperYachts (VSY). The company's inaugural offering is anything but novice, in fact, she is a splendid example of experience, superior design and expert management.

Viareggio Superyachts quietly crept onto the scene four years ago and worked in relative silence until winter 2009 when the shipyard delivered Candyscape II and her sister ship RoMa just four months later. In this stagnant period of global crisis affecting the industry, the delivery of two 62m ships in short succession was certainly of interest. A new company only by name, the VSY employee roster is teeming with years of experience in the industry. The builder was therefore quite well prepared to take on the challenges of constructing two 62m superyachts quite simultaneously.

Designed for Quality

Designed by naval architect Espen Oeino with interior design by Candy & Candy from London, the sophisticated Candyscape II is a marvel of modern technology and design, both inside and out. The initial concept of Viareggio Superyachts was one that combined the overall highest quality, eco-compatibility, implementation of advanced electronics on board, and enhanced manoeuvrability and control. With the outstanding management of VSY, interior builders from both Italy and Germany were put to work to make the early concept a reality. The end result is a superyacht with a stylish exterior, a glamorous interior and one of the most advanced electronic and navigation systems.

Green Star

From the very beginning of the project VSY was committed to build a superyacht to the highest environmental standards. Working with the classification society RINA, a Green Star environmental certification was developed for this type of yacht. Green features can be found throughout the ship. The sewage treatment system is based on a bio-disk purifier. The system is further improved by utilising sand and UV lamps before the water is discharged into the sea. The bilge water separator incorporated by the builder ensures reduced oil emissions of 5 ppm. In the unfortunate event of hull damage, the possibility of pollution is

reduced by small fuel deposits and an oversized fuel transfer system. There are also anti-particle filters and a CO catalyst on the three electric generator exhausts, therefore minimising carbon monoxide emissions.

Carbon Offset

In addition to the green features on board, the builder took the opportunity to carbon offset the sea trials for the yacht. In partnership with Yacht Carbon Offset, the emissions were balanced by green energy projects that offered equivalent greenhouse gas savings. Federico Bennewitz, General Manager of VSY, stated: "As a company, we have taken up the challenge of building superyachts to the highest environmental standards. Candyscape II and her sister ship show just what can be achieved with state-of-the-art

Green Star Certification

Italy-based classification society RINA has strengthened its commitment to environmentally friendly shipping in 2008 by launching a new goal-based class notation, Green Plus. The voluntary notation will be based on an environmental performance index which covers all aspects of the vessel's impact on the environment, including carbon emissions. RINA's Green Star notation has become a watchword for environmental excellence in shipping, anticipating the requirements of MARPOL and other relevant legislation, and placing Owners and operators in an advantageous position. Now, with Green Plus, RINA is taking the process one stage further by setting out a new class notation only to be granted to new vessels which make a significant investment in design solutions, onboard equipment, and operational procedures which contribute to an improvement in environmental performance beyond the minimum levels required by regulation. Design solutions and onboard equipment include anything which reduces the risk of pollution, or which lowers fuel consumption and air emissions. Innovative engine design, alternative fuels, high-efficiency propellers, optimal hull design and bio-degradable oils all fall into these categories. Operational procedures covered by a Green Plus notation include those which ensure that design solutions and onboard equipment are correctly used, voyage planning programmes resulting in reduced fuel consumption and emissions, or training courses designed to increase the environmental awareness of officers and crews.

i. www.rina.org





technology and innovative design. In our own operations we are always looking for new ways to minimise our impact on the environment. So for VSY, working with Yacht Carbon Offset was completely in line with our business priorities.” The shipyard’s implementation of green technology and features on board, and the carbon offsets for the sea trails resulted in Candyscape II being awarded the Green Star Plus certificate. Thanks to this certification as well as the same for sister ship RoMa, VSY has emerged as a leader in environmentally friendly yacht design and construction.

Integrated Systems

To achieve their goal of a top quality end product, VSY committed itself to use and work with the best components and the finest subcontractors and partners. Kongsberg supplied the elaborate navigation system that is fully integrated to create one of the first full paperless MCA compliant yachts. Kongsberg’s expertise was also used for the creation of a complex and advanced monitoring and automation system. With over 1,100 channels every single core system of the vessel is controlled and monitored by the central unit.

Rolls Royce steering gears and Caterpillar



engines and generators were installed, as well as a Brunvoll bow thruster and Schottel pump jet stern thruster, providing Candyscape II with the best machinery. As a result, all the above integrated machinery provides the yacht with a fully certified dynamic positioning system, that allows her to be moored with a joystick and also allows for green anchoring in natural marine parks.

Style to Perfection

For the yacht's interior, VSY lent an attentive eye to top quality in every detail. By managing the work of not one but two interior builders, VSY was

able to merge the flexibility and responsiveness of the Italian company Nieri with the strict adherence to quality of interior builder Oldenburger from Germany. The blending of work styles was not without its kinks, but the compromises that were born out of such differences are what proved to be most successful. This innovative approach to the interior build resulted in a fantastic realisation of the Candy & Candy design.

Intelligent Mirror

Candyscape II offers a number of unique features both luxurious and cutting-edge.



The 103” plasma screen television in the media room is one of the largest ever installed on a yacht and offers a digital library of films and other entertainment. Though certainly much smaller, the televisions in all of the guest bathrooms have the benefit of being waterproof. The master bathroom has not only a television but also an ‘intelligent mirror’ featuring a plasma screen and camera. A photo can be taken and stored in a computer to which the mirror is connected to show how dresses look from behind. On the main deck there is a circular sun bed that automatically rotates to face the sun, complete with sprays of cooling mist to keep your sun bathing comfortable at all times. All materials used throughout the interior are of the highest quality, neither VSY nor the Candy brothers were willing to settle for anything less than the best. To ensure the interior was built to perfection, VSY meticulously managed the work of interior builders, the naval architects and all subcontractors.

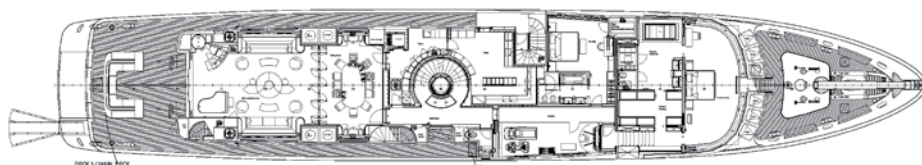
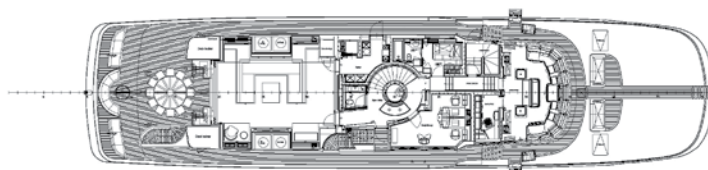
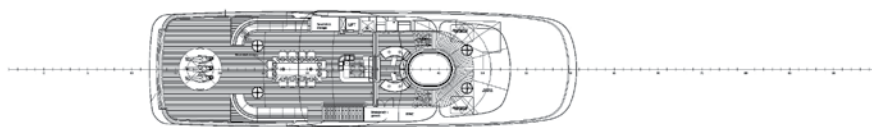
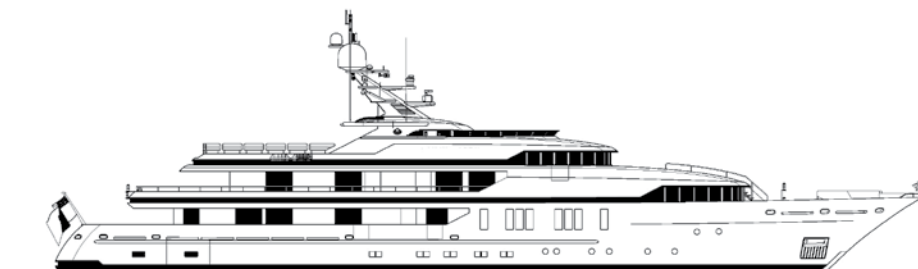

Big Forward

Candyscape II will be on her way back from a successful first charter season in the Caribbean. She is headed to the Mediterranean for the coming summer. Her sister ship RoMa finished her first photo shoot and is now heading for the Maldives for her first charter season. Having ships cover close to 70% of the globe, Viareggio Superyachts has now proven to be a reputable, respectable company. With the first two vessels well on their way, VSY is currently working on the third vessel of the 62m series, as well as another high tech and innovative ship, a 72m designed by Espen Oeino featuring another big forward step in green technology. Slated for delivery in 2012, the industry will surely be waiting to see what VSY comes out with next.



i. www.vsy-yachts.com

Facts & Figures Candyscape II

Principal Particulars

Length	61.80 m
Beam	11.80 m
Draught	3.10 m
Displacement	860 t
Fuel capacity	141 m ³
Water capacity	39 m ³

Installed Power

Main engines	2 x 2,000 kW Caterpillar diesels
Propulsion	Twin screw
Cruising Speed	15.5 knots
Range	3,500 nm at 14 knots

Classification

R.I.N.A. MCA Compliant